

NO.	QTY.	DESCRIPTION	MODEL NUMBER						INCLUDED IN SEAL KIT
			PI-5041-00 PI-5047-00 PI-5049-00 (1/2 bore)	PI-5071-00 PI-5077-00 PI-5079-00 (7/8 bore)	PI-5111-00 PI-5117-00 PI-5119-00 (1 1/8 bore)	PI-5141-00 PI-5147-00 PI-5149-00 (1 1/2 bore)	PI-5201-00 PI-5207-00 PI-5209-00 (2 bore)	PI-5241-00 PI-5247-00 PI-5249-00 (2 1/2 bore)	
1	1	SOCKET HEAD CAP SCREW	21-4100-55	21-4100-53	21-4100-53	21-4100-54	21-4100-54	21-4100-54	NO
2	1	ARM	91-5005-03	91-5009-03	91-5009-03	91-5015-03	91-5015-03	91-5025-03	NO
3	1	ROD WIPER, SNAP-IN	39-0530-07	39-0530-08	39-0530-08	39-0530-06	39-0530-06	39-0530-09	YES
4	1	ROD SEAL, U-CUP	39-0520-20	39-0520-21	39-0520-21	39-0520-18	39-0520-18	39-0520-26	YES
5	2	PLUG, CAM BUSHING	81-5905-04	81-5915-08	81-5915-08	81-5915-08	81-5915-08	81-5915-11	NO
6	2	O-RING, PLUG	39-0000-32	39-0000-53	39-0000-53	39-0000-53	39-0000-53	39-0000-53	YES
7	2	PISTON SEAL, U-CUP/LOADED LIP	39-0520-20	39-0520-18	39-0520-24	39-0520-22	39-0520-73	39-0520-19	YES
8	1	ROD ASSEMBLY, RIGHT HAND (SHOWN)	P9-1504-01	P9-1507-01	P9-1511-01	P9-1514-01	P9-1520-01	P9-1524-01	NO
	1	ROD ASSEMBLY, LEFT HAND	P9-1504-02	P9-1507-02	P9-1511-02	P9-1514-02	P9-1520-02	P9-1524-02	NO
	1	ROD ASSEMBLY, STRAIGHT	P9-1504-03	P9-1507-03	P9-1511-03	P9-1514-03	P9-1520-03	P9-1524-03	NO
9	1	O-RING, END CAP	39-0000-31	39-0500-26	39-0500-85	39-0510-46	39-0510-47	39-0511-97	YES
10	1	END CAP	81-5305-03	81-5309-04	81-5311-00	81-5315-00	81-5320-00	81-5325-00	NO
11	1	BUSHING, SC, 1/2	81-5905-07	N/A	N/A	N/A	N/A	N/A	YES
N/A	N/A	TORQUE FOR CAM BUSHING PLUG	1-2 IN LB	3-4 IN LB	3-4 IN LB	3-4 IN LB	3-4 IN LB	3-4 IN LB	N/A
N/A	N/A	TORQUE FOR END CAP	4-6 IN LB	48-52 IN LB	48-52 IN LB	15-17 FT LB	15-17 FT LB	15-17 FT LB	N/A
N/A	N/A	SEAL KIT	60-1522-01	60-1522-02	60-1522-03	60-1522-04	60-1522-05	60-1522-06	N/A
N/A	N/A	VEKTEK SEAL INSERTION TOOL	AT-5015-01	AT-5015-02	AT-5015-03	AT-5015-04	AT-5015-05	AT-5015-06	N/A

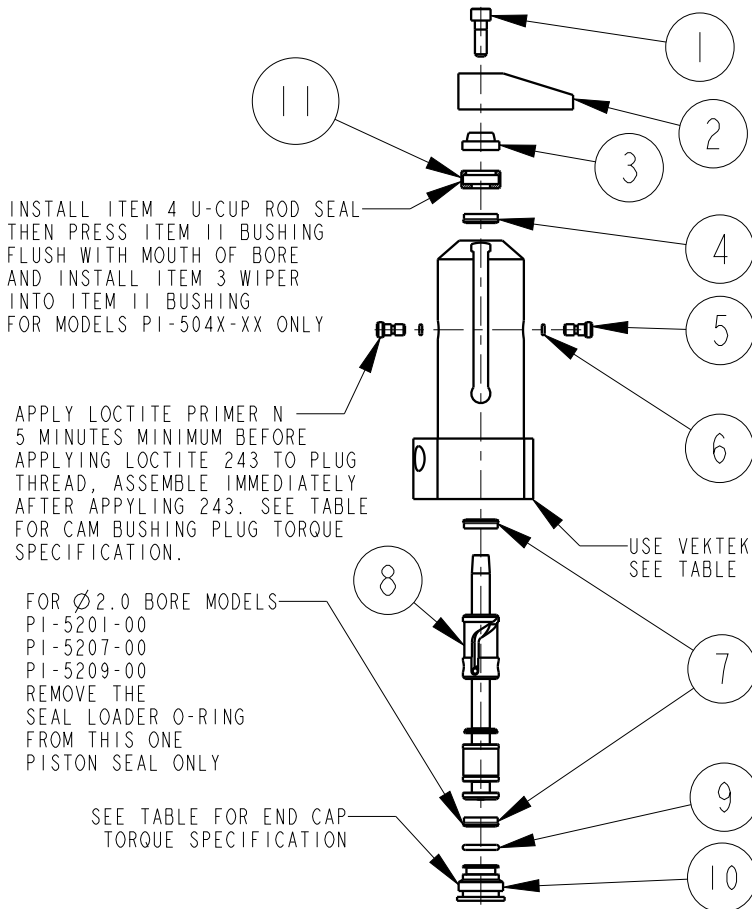

DURING ASSEMBLY BE SURE THAT AS THE CAM BUSHING PLUGS (ITEM 5) ARE BEING TORQUED INTO THE BODY THAT THEY ENGAGE THE RETAINING HOLES IN THE CAM BUSHING LOCATED ON THE ROD ASSEMBLY (ITEM 8).

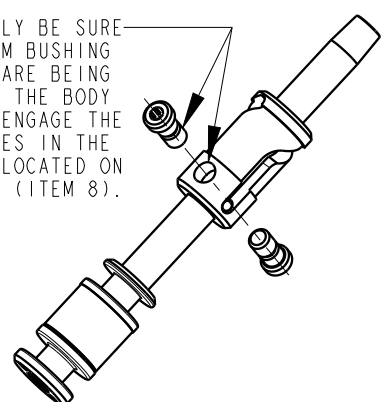

NOTES:
1. APPLY LUBRICANT TO ALL SEALS PRIOR TO INSTALLATION.
2. SEE EN-6000 FOR SEAL KITS.

ASSEMBLIES AFFECTED		
PI-5041-00,	PI-5047-00,	PI-5049-00
PI-5071-00,	PI-5077-00,	PI-5079-00
PI-5111-00,	PI-5117-00,	PI-5119-00
PI-5141-00,	PI-5147-00,	PI-5149-00
PI-5201-00,	PI-5207-00,	PI-5209-00
PI-5241-00,	PI-5247-00,	PI-5249-00

PARTS LIST	
	VEKTEK, INC. 1334 E. SIXTH AVE. P.O. BOX 625 EMPORIA, KS. 66801 U.S.A.
ASSEMBLIES AFFECTED: SEE ABOVE FOR LIST	PARTS LIST, ASSY, SC, BF, PNEU
SIZE A	PPL1502
REV F	

F	5908	RELEASE	JDW	02/20/26
REV	IN ACCORDANCE WITH ECN	EFFECTIVE DATE	REVISED BY	DATE
DRW BY:	JDW	DRAWING STATUS: Released		
DATE:	04/05/05	PRODUCTION APPROVED FOR RELEASED STATUS ONLY		